



# **BATMAZ**

DEFENCE INDUSTRIES

---

## ***FOCUS***

### **OVER UNDER SHOTGUN INSTRUCTION MANUAL**

---

**READ THE INSTRUCTIONS AND  
WARNINGS IN THIS MANUAL  
CAREFULLY BEFORE USING THIS  
FIREARM**

BECAUSE OF THE TRAPPED MOISTURE THAT MAY CAUSE RUSTING IT IS NOT ADVISABLE TO STORE YOUR SHOTGUN IN A CARRY CASE.

## **2-SAFETY RULES**

**WARNING: THE FAILURE TO FOLLOW THESE SHOTGUN SAFETY REQUIREMENTS WILL CAUSE SERIOUS PERSONAL INJURY OR DEATH TO YOU OR OTHERS.**

- ALWAYS TREAT A FIREARM AS IF IT WERE LOADED. NEVER ASSUME THAT IT IS UNLOADED.
- NEVER POINT THE FIREARMS AT SOMETHING THAT IS NOT SAFE TO SHOOT.
- STORE ALL THE FIREARMS SO THAT CHILDREN CANNOT GAIN ACCESS TO THEM. IT IS YOUR RESPONSIBILITY TO INSURE THAT UNAUTHORIZED PERSONS DO NOT GAIN ACCESS TO YOUR FIREARM. TO REDUCE THE RISK OF ACCIDENTS INVOLVING CHILDREN, UNLOAD YOUR FIREARM, LOCK IT AND STORE THE AMMUNITION IN A SEPARATE LOCKED LOCATION.
- ALWAYS WEAR ADEQUATE AND PROPER EAR PROTECTORS.
- ALWAYS WEAR SAFETY PROTECTIVE GLASSES SPECIFIED FOR FIREARM USE.
- ALWAYS BE ALERT AND ALWAYS FOLLOW THE SAFETY INSTRUCTIONS OF THE RANGE OFFICER. NEVER SHOOT IF YOU ARE TIRED, COLD OR IMPAIRED IN ANY WAY.
- ALWAYS BE AWARE OF OTHER PEOPLE SO THAT PERSONS CANNOT ACCIDENTALLY WALK INTO THE LINE OF FIRE.
- THE SHOOTER (AND ALL OTHERS IN THE SHOOTING AREA) MUST ALWAYS BE IN A POSITION THAT IS OUT OF THE LINE OF FIRE.
- NEVER SHOOT AT HARD SURFACES, WATER OR RANDOMLY INTO THE SKY. ALWAYS SELECT A PLACE TO SHOOT THAT HAS A SAFE BACKSTOP AND IS FREE FROM OBSTRUCTIONS AND WATER SURFACES WHICH CAUSE RICOCHETS.
- NEVER CLIMB A TREE, FENCE OR OBSTRUCTION WITH A LOADED FIREARM. OPEN AND EMPTY THE CHAMBER OF YOUR FIREARM AND ENGAGE THE MANUAL SAFETY BEFORE CLIMBING OR DESCENDING A TREE OR BEFORE CLIMBING A FENCE OR JUMPING OVER A DITCH OR OBSTRUCTION.
- NEVER TRANSPORT A LOADED FIREARM.
- NEVER USE ALCOHOL OR DRUGS BEFORE OR WHILE SHOOTING OR HANDLING ANY FIREARM.

### 3-NOMENCLATURE

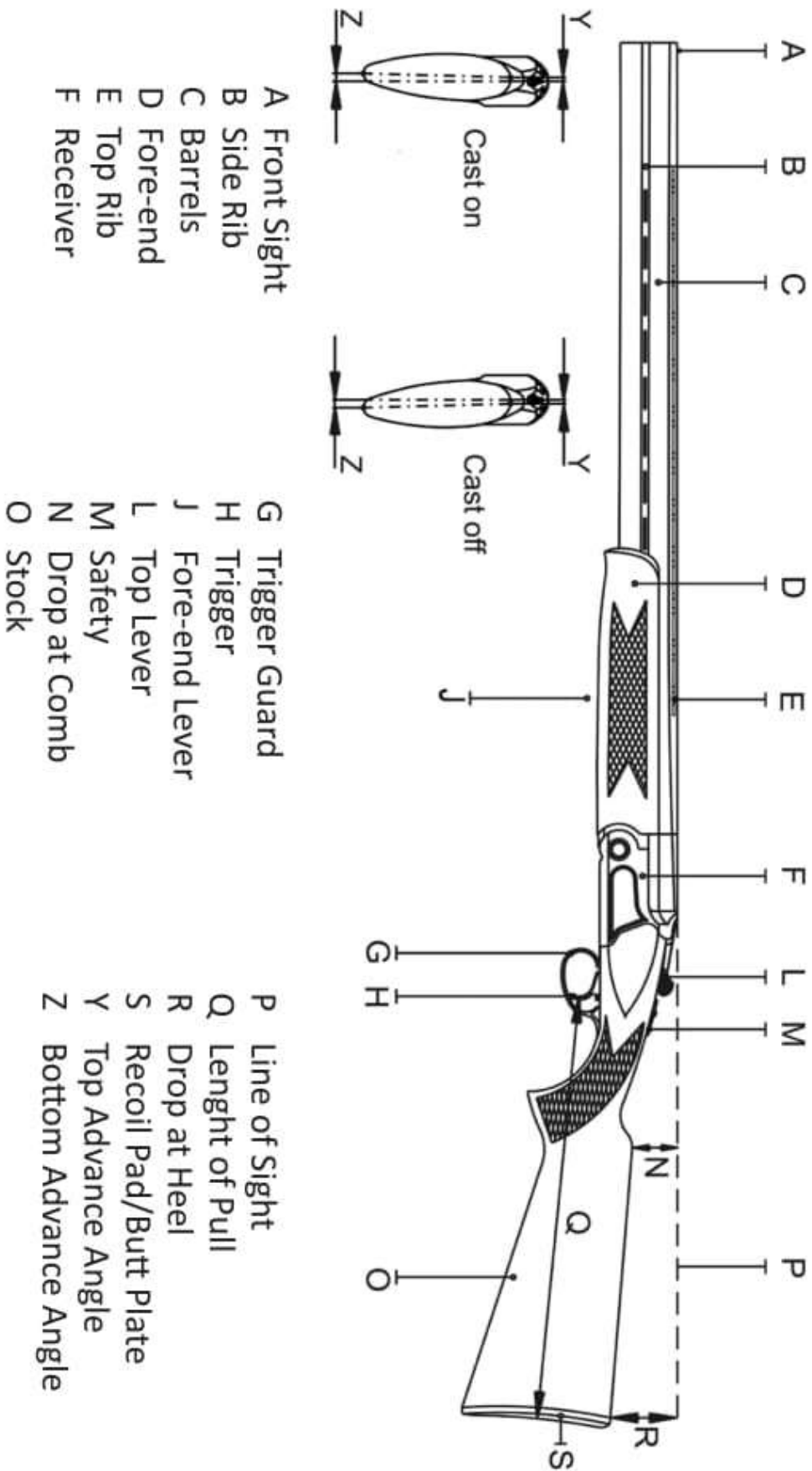



## 4-INITIAL ASSEMBLY AND INSPECTING

- Your shotgun is shipped from the factory with the barrel and the fore-end not assembled to the receiver (Figure 1).



Figure 1

- Remove the fore-end from the barrel by pulling down on the fore-end lever (Figure 2&3).



Figure 2

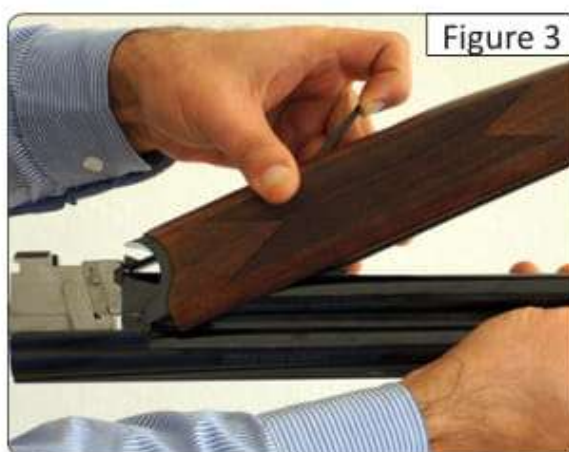

Figure 3

- To attach the barrel to the receiver, move the top lever to the right (Figure 4).
- Holding the barrel assembly in one hand and the frame assembly in the other hand, engage the recess in the barrel lug onto the hinge pin in the frame (Figure 5).



Figure 4



Figure 5

## 4-INITIAL ASSEMBLY AND INSPECTING

- Rotate the barrel upwards from the muzzle to close the action (Figure 6).
- Place the rear of the fore-end iron against the receiver and carefully rotate the fore-end into place (Figure 7).



- Push the fore-end lever closed – flush with the fore-end surface to lock it into place (Figure 8).
- Make sure the safety is in the “SAFE” position (Figure 14&15).
- Move the top lever to the right and open the action (Figure 9).
- Always keep your fingers away from the trigger when closing the action (Figure 6).



- When you inspect your shotgun you should first check to ensure that it is unloaded. To do this, open the action and look into the barrel from the breech end and make sure there are no shells in the chambers (figure 10).
- Verify that the barrel is clear and free of obstructions.
- Always keep your fingers away from the trigger when closing the action (Figure 11).





## 5-LOADING AND USAGE

- Do not load the shotgun until you have read and fully understand this manual, and you are ready to use it.
- Point the muzzle downward and in a safe position.
- Move the top lever to the right to open the action (Figure 12).
- Look into the barrel from the breech end and make sure there are no obstructions in the barrel.
- Engage the safety if it is not already engaged (Figure 14&15).
- Place a shell which is only factory-loaded, new ammunition into each chamber (Figure 13). Be certain that each round you use is in the proper gauge. The gauge of the firearm is clearly marked on the barrel.



- Close the action (Figure 11).
- Always keep your finger away from the trigger whenever you do not intend to fire.
- Move safety fully forward to the "FIRE" position. Your shotgun has a selector safety system. The top barrel fires first when you move the safety to the left and forward (Figure 16); and when you slide it to the right and forward, the bottom barrel fires first (Figure 17). Your gun is in the safe mode when you pull the safety backwards on either side (Figure 14&15).
- The shotgun is now ready to fire.
- Always keep your fingers away from the trigger when closing the action (Figure 11).



## 6-UNLOADING

First of all, set the safety to the "SAFE" position (Figure 14&15).

### **Ejector**

- Move the top lever to the right and open the action.

SHELLS WILL EJECT FROM THE SHOTGUN WITH A FORCE. BE AWARE OF WHAT IS BEHIND AND BY THE SIDE OF THE SHOTGUN BEFORE OPENING THE ACTION.

If you have pulled the trigger once, the first shell will eject when you open the shotgun and you will have to remove the second shell manually. If you have pulled the trigger twice, both shells will eject with a force when the barrels are opened.

However, if you have not pulled the trigger at all and want to unload the shotgun, you will have to remove the shells manually from the chambers after opening the mechanism.

### **Decocking Hammers/Un-Cocking the Trigger Mechanism**

To decock the hammers without the possibility of firing pin damage, place a snapcap in each barrel before pulling the triggers (Figure 18).



Figure 18

## 7-DISASSEMBLY /RE-ASSEMBLY

- Verify that the chambers are empty and close the action.
- Pull down on the fore-end lever and remove the fore-end (Figure 19).
- Move the top lever to the right and open the action (Figure 20).
- Pivot the barrel downward from the muzzle and remove the barrel assembly from the receiver (Figure 21&22).









## 7-DISASSEMBLY /RE-ASSEMBLY

- Before re-assembly, verify that the barrels are free of bore obstructions.
- Holding the barrel assembly in one hand and the frame assembly in the other hand, engage the barrel pivot onto the hinge pin within the frame (Figure 23).
- Rotate the barrel upwards at the muzzles to close the action (Figure 24).
- Place the rear of fore-end iron against the receiver (Figure 25). Align the fore-end latch hook into the receiver and carefully snap the fore-end into place.
- Push the fore-end lever closed – until it is flush with the fore-end surface (Figure 26).



## 8-USE OF CHOKE TUBES

With the choke tubes you can controls the openness or tightness of the pattern of your shotgun. The chart below lists the chokes available (from open to tight), and the corresponding marks that indicate the choke of your shotgun.

CHOKE	TRUE CYLINDER	1/4	1/2	3/4	FULL
AMERICAN DESIGNATION	CL (Cylinder)	IC (Improved Cylinder)	M (Modified)	IM (Improved Modified)	F (Full)
CHOKE TUBE					
NOTCHES	★★★★★	★★★★	★★★	★★	★
COMPATIBILITY WITH STEEL SHOT	Recommended	Recommended	Recommended	Do Not Use	Do Not Use
BEST IN THE AREA OF	Sporting, clay and skeet shooting. Short distance, more open shooting.	Quail, dove and target shooting. For shorter distance more open shooting.	Hunting woodcock, pheasant & quail with 30-35 yard shots. Long range hunting with steel shot and tight groups.	For hunting pheasant, ducks with 30-40 yard shots.	For duck and goose hunting with 40-45 yard shots. For long range hunting with lead shot and tight groups.

All the five choke tubes are included in the package in a specially designed box (Figure 27).



**WARNING:** When installing a choke tube in your barrel, make sure that the tube is completely screwed down tight in the barrel, never shoot your shotgun without the choke tubes installed as this may damage the barrel and injure the shooter. Choke tubes may become loose after extended firing and should be checked frequently of tightness.



## 8-USE OF CHOKE TUBES

### INSTALLATION OF CHOKE TUBES

**WARNING:** Check that the firearm is unloaded. If not, unload the firearm by operating as described in the chapter "Unloading". Never look into the muzzle or change tubes on a loaded gun, even with safety is set to "on".

- Either open the action or lift the barrel out of the receiver.
- Apply a thin coat of gun oil to the threads of the barrels and of the choke tubes.
- Insert the desired chokes into the choke housings. Take care the notched end will be upside.
- Carefully hand screw the chokes into the barrels clockwise (Figure 29).
- Using the choke tube wrench tighten the chokes until they are fully bottomed into their recesses in the barrels.
- Remove the choke tube wrench after tightening.



### REMOVAL OF CHOKE TUBES

**WARNING:** Check that the firearm is unloaded. If not, unload the firearm by operating as described in the chapter "Unloading". Never look into the muzzle or change tubes on a loaded gun, even with safety engaged.

- Either open the action or lift the barrel out of the receiver.
- Unscrew (counterclockwise) the choke tubes using the choke tube wrench supplied (Figure 30). Remove the choke tubes from the muzzle (Figure 31 ).

### CLEANING OF CHOKE TUBES

**WARNING:** Check that the firearm is unloaded. If not, unload the firearm by operating as described in the chapter "Unloading". Never look into the muzzle or change tubes on a loaded gun, even with safety is set to "on".

- Either open the action or lift the barrel out of the receiver.
- Carefully clean the choke housing. If necessary, use a cotton patch coated with gun oil.
- Check the choke to make sure it is perfectly clean inside and outside.
- Apply a thin coat of gun oil to the threads of the barrels and of the choke tubes.



## 12-PARTS LIST

NO	PART NAME
1	Barrel
2	Ejector Spring (2 Pcs.)
3	Ejector Spring Pin (2 Pcs.)
4	Bottom Ejector Rod
5	Top Ejector Rod
6	Slide Spring (2 Pieces)
7	Slide Retainer Pin (2 Pcs.)
8	Right Slide
9	Left Slide
10	Choke Tube (5 Pieces)
11	Sight Bead
12	Fore-end Iron
13	Cocking Arm
14	Cocking Arm Screw
15	Latch Housing
16	Latch Spring
17	Retainer Latch
18	Latch Retainer Pin
19	Fore-end Wood
20	Fore-end Wood Screw (2 Pcs.)
21	Fore-end Iron Retainer Screw (2 Pcs.)
22	Receiver
23	Receiver Main Screw (2 Pcs.)
24	Locking Bolt
25	Top Lever
26	Top Lever Spring Cap
27	Top Lever Spring
28	Top Lever Spring Pin
29	Top Lever Retainer Screw
30	Firing Pin Spring (2 Pieces)
31	Firing Pin (2 Pieces)
32	Firing Pin Retainer Pin (2 Pcs.)

NO	PART NAME
33	Left Cocking Rod
35	Safety Slide
36	Safety Slide Spring
37	Safety Screw
38	Safety Screw Nut
39	Left Hammer
40	Right Hammer
41	Hammer Pin
42	Sear Spring (2 Pcs.)
43	Left Sear
44	Right Sear
45	Sear Pin
46	Selector Block
47	Trigger
48	Selector Block Screw
49	Trigger Spring
50	Trigger Pin
51	Trigger Plate
52	Top Lever Retainer Spring
53	Top Lever Retainer
54	Trigger Plate Pin
55	Trigger Guard
56	Front Trigger Guard Pin
57	Rear Trigger Guard Pin
58	Hammer Spring (2 Pcs.)
59	Hammer Spring Pin (2 Pcs.)
61	Stock
62	Stock Washer
63	Through Bolt
64	Butt
65	Butt Screw (2 Pcs.)

## INDEX

1. WARRANTY .....	3
2. SAFETY RULES .....	4
3. NOMENCLATURE .....	5
4. INITIAL ASSEMBLY AND INSPECTING .....	6-7
6. LOADING AND USAGE .....	8
7. UNLOADING .....	9
8. DISASSEMBLY/ REASSEMBLY .....	10-11
11. USE OF CHOKE TUBES .....	12-13
12. PARTS LIST .....	14
13. EXPLODED VIEW .....	15-16
14. CLEANING AND MAINTENANCE .....	17

## 13-EXPLODED VIEW

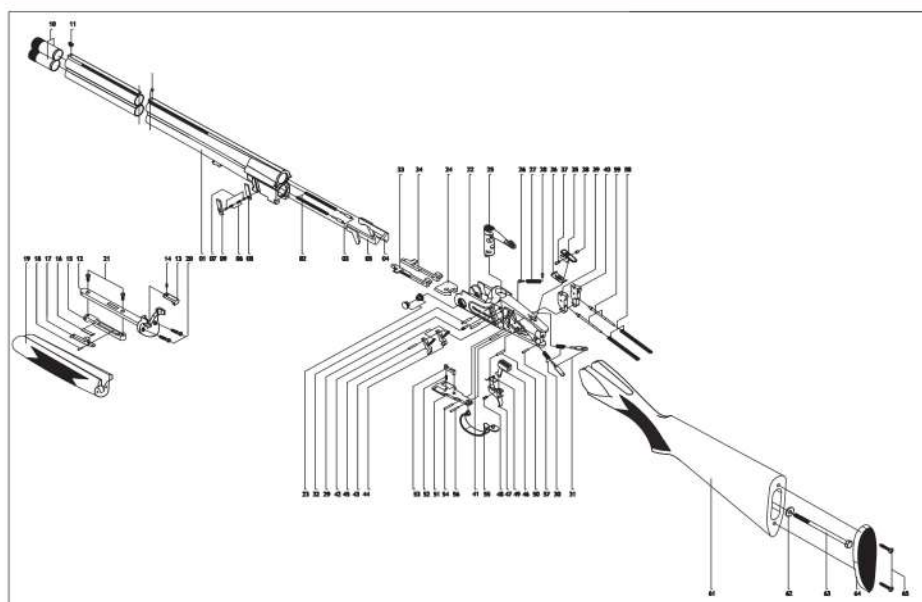

-15-

-16-

## QUALITY CONTROL - WARRANTY CARD

Serial No. of weapon \_\_\_\_\_ Model \_\_\_\_\_

Manufacturer \_\_\_\_\_

Caliber \_\_\_\_\_ Year of manufacture \_\_\_\_\_ Barrel Length \_\_\_\_\_

Number of Cartridges and grams of cartridges tested \_\_\_\_\_

Chamber details \_\_\_\_\_

PURCHASER \_\_\_\_\_

Address \_\_\_\_\_

Purchase date \_\_\_\_\_

Signature \_\_\_\_\_

PLEASE SIGN AND RETURN THIS CARD TO VALIDATE WARRANTY





# BATMAZ

## DEFENCE INDUSTRIES

### NOTICE:

This firearm was carefully inspected and test fired before shipment from our factory. However, we cannot control the handling of these firearms once they leave our factory. For your own protection; please examine the gun carefully at the time of purchase. The mechanism has been correctly designed, fitted and tested. However, any mechanical device can fail and no mechanism can prevent accidents caused by careless or thoughtless handling. Never permit the muzzle to point at anything which you do not wish to shoot. Always check to make sure that the gun is unloaded before handling. Be sure of your backstop or direction of fire before shooting.

**Beytepe Mahallesi Şehit İdris Ulu Caddesi No:1/A**  
**Beyşehir, Konya, TÜRKİYE**