



# **BATMAZ**

DEFENCE INDUSTRIES

---

## ***LSM 12***

### **LEVER ACTION SHOTGUN INSTRUCTION MANUAL**

---

**READ THE INSTRUCTIONS AND  
WARNINGS IN THIS MANUAL  
CAREFULLY BEFORE USING THIS  
FIREARM**

Congratulations on your purchase of a Batmaz Group Lever Action Shotgun. With proper care and handling, it will give you long, reliable service.

We specifically disclaim any responsibility for damage or injury whatsoever, occurring as a result of the use of faulty, non-standard or remanufactured ammunition, any modifications or changes made to the firearm; improper use or unsafe handling of the firearm.

Always keep this manual with your firearm. Make sure you understand all the warnings, operating instructions and safety procedures. When you lend, give or sell the firearm, be sure this manual goes with it. You can get a copy of this manual from Black Aces Tactical on request.

**FIREARMS SAFETY IS THE SOLE RESPONSIBILITY OF THE SHOOTER. ALWAYS TREAT ALL FIREARMS AS IF THEY WERE LOADED AT ALL TIMES!**



**IMPORTANT!**

READ ALL INSTRUCTIONS AND WARNINGS IN THIS BOOKLET BEFORE USING THIS FIREARM.

## **GUN SAFETY RULES**

Observe these rules of safe gun handling.

- 1.** Always keep the muzzle pointed in a safe direction. Watch the muzzle at all times: never point a gun, accidentally or intentionally, at any person or anything you do not intend to shoot. identify the target before shooting; do not shoot at sounds.
- 2.** Always treat any gun as if it is loaded - it may be!
- 3.** Keep your finger off the trigger while operating the action and at all other times until you are ready to shoot.
- 4.** Keep the safety "on" or in the "safe" position at all times until you are ready to fire the gun.

Do not rely on your gun's safety, the safety on any gun is a mechanical device and is not intended as a substitute for common sense or safe gun handling.

- 5.** Learn how your gun functions and handles. If you do not thoroughly understand the proper use and care of your gun, seek the advice of someone who is knowledgeable.
- 6.** Do not alter or modify and parts of a firearm.
- 7.** Store guns unloaded, separate from any ammunition, and where children cannot get to them.
- 8.** Be sure the barrel is clear of any obstructions before loading. Make it a habit to check the barrel every time before loading.
- 9.** Be sure you have and use the proper ammunition. A 20-gauge shell will enter a 12-gauge chamber far enough so that a 12-gauge shell can be loaded behind it. Also, a 3-inch shell may fit into a 2 3/4-inch chamber, but the crimp at the mouth of the shell will unfold into the forcing cone. If either of these things occur and you fire the gun, the gun will explode, damaging the gun and possibly causing serious injury or death to you and those around you.
- 10.** Wear protective shooting glasses and adequate ear protection when shooting.
- 11.** Never climb or jump over anything, such as a tree, fence, or ditch, with a loaded gun. Open the barrel, remove the shells, and hand over the gun to a friend



**A.** The safety is located left side of the receiver, and provides protection against accidental or unintentional discharge under normal usage when properly handled.

**B.** To engage the safety, push the button so that it protrudes from the right side of the gun and the RED BAND MARKING CAN NOT BE SEEN. The safety should always be in the "RED" or "WHITE" position until you intend to fire the gun.

**C.** When you are ready to fire the gun, press the safety button to the "RED" or "FIRE" position, so that the safety protrudes from the left side of the gun and the **RED BAND MARKING IS SHOWING**.

**DANGER:** The gun will fire when the trigger is pulled intentionally or accidentally when the **RED BAND MARKING IS SHOWING**.

### DISASSEMBLY



**1** - Safety ; Red is ready to fire & white is safe mode.



**2** - Remove the forend cap by turn it to anti-clockwise.



**3** - Remove forend & barrel assembly together by pulling forward.



**4** - Take down the receiver pins by pressing with external screw.



**5** - Over view of pins from downward.



**6** - Take out the trigger assembly by pushing it outside.



**7** - First remove the screw of rubber pad and than take out the screw of stock/butt.



**8** - Same way as explained previously to take off the grip remove the nut / screw from inside of grip.



**9** - Assembled gun in action mode.

## **ASSEMBLY**

Assembly of gun is vise versa as explained above.

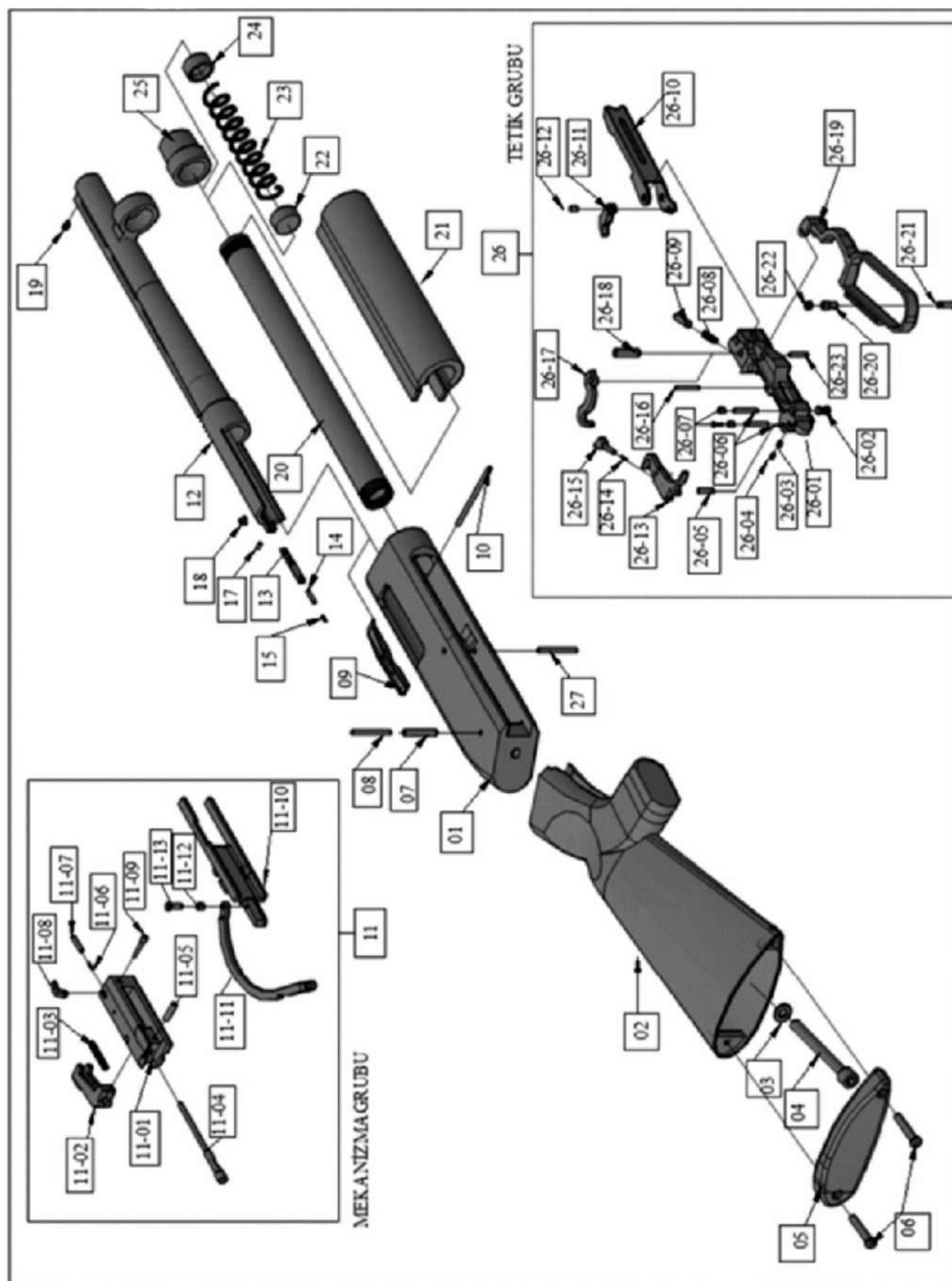

# PARTS LIST

01	Receiver	19	Brass Bead
02	Stock	20	Magazine Tube
03	Stock Connection Bolt Washer	21	Forend
04	Stock Connection Bolt	22	Magazine Follower
05	Synthetic Stock Pad	23	Magazine Spring
06	Stock Pad Screws	24	Magazine End
07	Ayceki ( Lever Arm ) Stopper Reel	25	Barrel Connection Nut Complete
08	Ayceki ( Lever Arm ) Stopper Pin	26	Trigger
09	Magazine Stop Complete	26-01	Trigger Body
10	Magazine Stop Connection Pin	26-02	Safety
11	Bolt	26-03	Safety Push Reel
11-01	Bolt Body	26-04	Safety Push Spring
11-02	Locking Lug	26-05	Safety Push Connection Pin
11-03	Firing Pin Spring	26-06	Ayceki ( Lever Arm ) Stop Connection Pins
11-04	Firing Pin	26-07	Ayceki ( Lever Arm ) Stop Reels
11-05	Firing Pin Connection Pin	26-08	Operating Handle Spring
11-06	Extractor Spring	26-09	Operating Handle Reel
11-07	Extractor Pin	26-10	Carrier
11-08	Extractor	26-11	Carrier Hand
11-09	Extractor Connection Pin	26-12	Carrier Connection Pin
11-10	Bolt Carrier	26-13	Trigger
11-11	Ayceki ( Lever Arm )	26-14	Hammer Sear Spring
11-12	Ayceki ( Lever Arm ) Connection Nut	26-15	Hammer Sear
11-13	Ayceki ( Lever Arm ) Connection Bolt	26-16	Hammer Sear Connection Pin
12	Barrel	26-17	Hammer
13	Ejector	26-18	Hammer Connection Reel
14	Ejector Pin	26-19	Operating Hand Lever
15	Ejector Pin Spring	26-20	Ayceki ( Lever Arm ) Connection Pin
17	Ejector Screw Front	26-21	Ayceki ( Lever Arm ) Handle Reel Screw
18	Ejector Screw Back	26-22	Ayceki ( Lever Arm ) Handle Reel
		26-23	Ayceki ( Lever Arm ) Connection Screw
		27	Trigger Guard Dissassembly Pin

## Main Technical Data

Item	Technical Data
Gauge	12
Weight	2.5 – 2.6 kg
Feed Method	Magazine Tube
Barrel Length	18,5"-20"-24"- 28"

## Safety Switch or Button

The safety is designed to stop the trigger mechanism.

A) The safety is located behind the trigger and provides protection against accidental or unintentional discharge under normal usage when properly used.







B) To engage the safety, push the button so that it protrudes from the right side of the gun until it protrudes through to the left side of the gun. The safety should always be in the "ON" or "SAFE" position until you intend to fire the gun.

C) When you are ready to fire the gun, press the safety button to the "OFF" position so that the safety protrudes from the left side of the gun and the red band marking is showing .



## USAGE OF CHOKE TUBES

The choke is what controls the openness or tightness of the pattern of your Shotgun. The chart below lists the choke available (from open to tight), and the corresponding marks that indicate the choke of your specific shotgun.

	SKEET	IC	M	IM	F	XF
CHOKE TUBE						
BBLS	CL	****	***	**	*	XF

Never fire or run gun cleaning tools through a barrel that uses choke tubes without having a choke tube installed. The threads of the choke tube and the internal threads of the barrel should be cleaned after each use and before installation of the tube.

To install a tube, insert the tube into the barrel and tighten with your fingers. Once the tube is finger tightened, tighten with the appropriate choke tube Wrench until the tube sits on the threads. DO NOT over tighten or forcefully tighten with wrench.

## MAINTENANCE AND CLEANING

**Caution:** Make sure the gun is unloaded.

1. Make sure that the broad, polished, finely fitted mating surfaces of the breech block and receiver are especially clean and lightly oiled with a high quality gun oil. Do not use pure silicone.
2. Run an oil patch through the bore with a cleaning rod starting from the breech end. To prevent leading, use a cleaning solvent and brass brush to clean the bore periodically. Follow this cleaning with one or two clean oil patches.

**Important:** If your gun is equipped with choke tubes, do not use a brass brush to clean the barrels unless a choke tube is installed in each barrel. Barrels that utilize choke tubes must also have the choke tubes removed to clean and oil the threads inside the barrel and the choke tubes themselves. This will protect the threads from being damaged by cleaning tools and also prevent a dirt build up that would cause the choke tube to become difficult to remove from the barrel. Damage can result to choke tubes and barrel when attempting to remove sticky choke tubes. Never fire your gun without choke tubes tightened in barrels. Do not over tighten choke tubes. Wipe all exposed metal surfaces with an oiled cloth before storing. Do not pour oil into the inside mechanism because it may hamper proper functioning and will soak

the wood. After extended periods of heavy use, your gun should be taken to a qualified gun smith to have the action disassembled for professional cleaning and lubrication.

**3.** Care for your wood stock and fore arm the same way you would a piece of furniture with the same finish.

### **STORAGE**

Clean thoroughly and oil your gun before storage. Store the gun in a case to prevent scratches and dents. Store in a dry place to prevent corrosion.

Store the gun away from children and in place where it cannot be obtained by those unauthorized to use it. Always store gun unloaded and separately from any ammunition.

### **PARTS**

To order parts, please mention the following information: Your name, address, telephone number, firearm serial number, make and model. When we receive your request we will send you an order form and a parts breakdown with prices.

## QUALITY CONTROL - WARRANTY CARD

Serial No. of weapon \_\_\_\_\_ Model \_\_\_\_\_

Manufacturer \_\_\_\_\_

Caliber \_\_\_\_\_ Year of manufacture \_\_\_\_\_ Barrel Length \_\_\_\_\_

Number of Cartridges and grams of cartridges tested \_\_\_\_\_

Chamber details \_\_\_\_\_

PURCHASER \_\_\_\_\_

Address \_\_\_\_\_

Purchase date \_\_\_\_\_

Signature \_\_\_\_\_

PLEASE SIGN AND RETURN THIS CARD TO VALIDATE WARRANTY





# BATMAZ

## DEFENCE INDUSTRIES

### NOTICE:

This firearm was carefully inspected and test fired before shipment from our factory. However, we cannot control the handling of these firearms once they leave our factory. For your own protection; please examine the gun carefully at the time of purchase. The mechanism has been correctly designed, fitted and tested. However, any mechanical device can fail and no mechanism can prevent accidents caused by careless or thoughtless handling. Never permit the muzzle to point at anything which you do not wish to shoot. Always check to make sure that the gun is unloaded before handling. Be sure of your backstop or direction of fire before shooting.

Beytepe Mahallesi Şehit İdris Ulu Caddesi No:1/A  
Beyşehir, Konya, TÜRKİYE